

Plan W6903AM: Craftsman Home Plan with Bonus Room

<http://www.architecturaldesigns.com/house-plan-6903AM.asp>

Plan No: W6903AM	9' ceilings prevail throughout the first floor of this comfortable Craftsman home plan, as well as in the dormered bonus room over the garage which gives you an additional 358 sq. ft. if you build it out. To the left of the entry foyer lies a study or office with built-ins. In the open living area, interior columns define the space, separating the dining room from the great room. Windows across the rear wall let in lots of light. A fireplace warms the great room, the adjacent kitchen and bayed breakfast nook. The kitchen features an island with an eating bar, twin sinks, dishwasher and pantry closet. Upstairs, the vaulted master bedroom opens to a walk-in closet and a bath with spa tub, walk-in shower and dual lavatories. Another full bath serves the remaining bedrooms. A laundry room with its own sink completes this level. The third bay in the tandem-style garage can be used for an additional car or for storage. The staircase for the basement option is located where the main floor powder room is. The powder room is relocated off the kitchen into the third car garage/storage space area.
Style: Craftsman, Northwest	
Total Living Area: 1,946 sq. ft.	
Main Flr.: 1,082 sq. ft.	
2nd Flr: 864 sq. ft.	
Deck: 120 sq. ft.	
Attached Garage: 3 Car, 610 sq. ft.	
Bedrooms: 3/4	
Full Bathrooms: 2	
Half Bathrooms: 1	
Width: 40'	
Depth: 52'	
Maximum Ridge Height: 27'	
Exterior Walls: 2x6	
Ceiling Height:	
Main Floor: 9'	
2nd Floor: 9'	
Other: vaulted master bedroom	
Standard Foundations: Crawl	
Optional Foundations: Slab (\$95), Basement (\$225)	

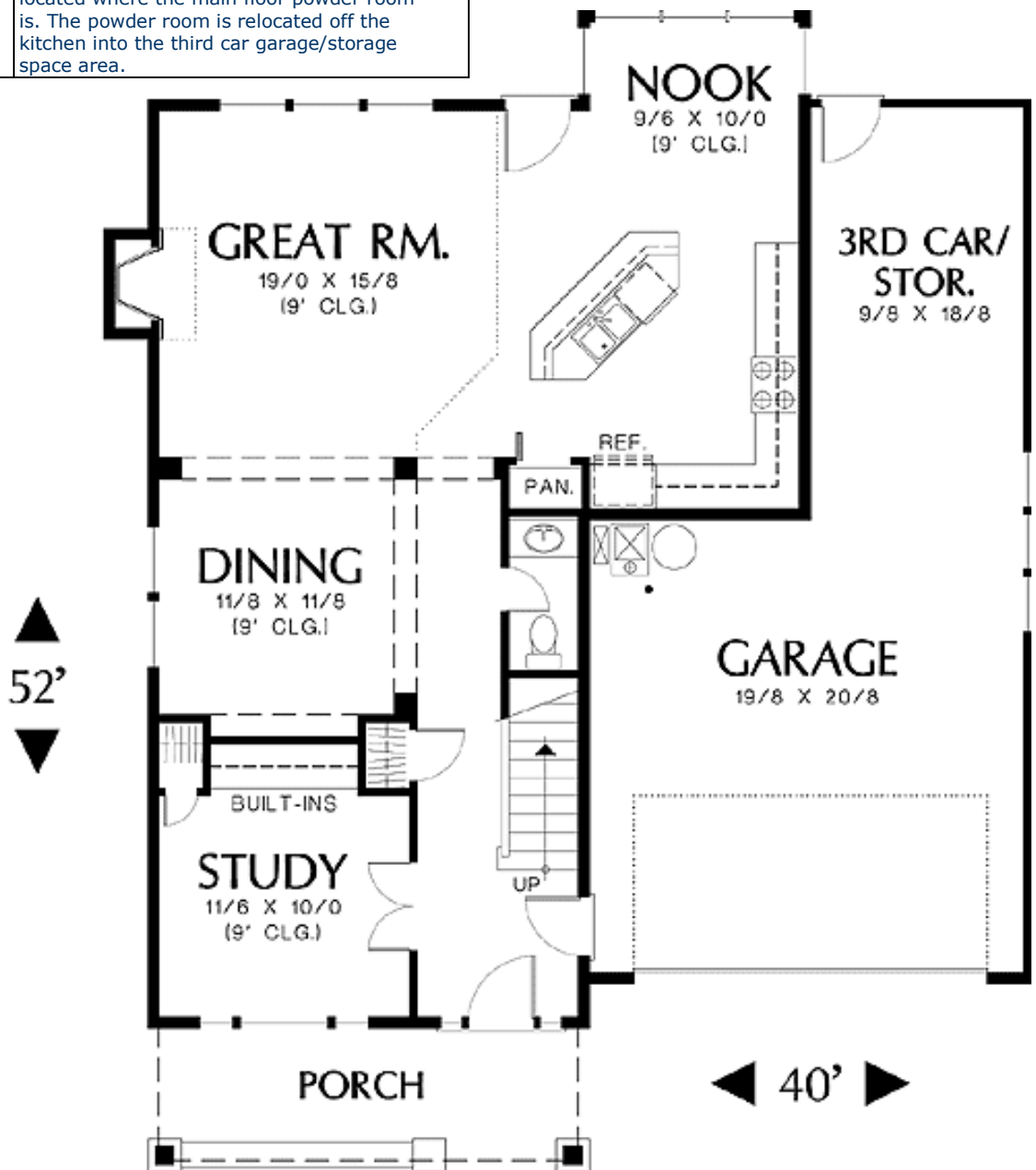

Plan W6903AM: Craftsman Home Plan with Bonus Room

